

Area Safety Liaison Annual Training 2020



ASL Training 2020

- Thank you for your service as an ASL!!!
- Due to the ongoing COVID-19 situation, we will not hold an in-person training this year
- Please review the contents of this training PowerPoint to re-familiarize yourself with ASL roles and responsibilities
- Contact EHS at 713 500 8100 if you have any questions or concerns
- We look forward to resuming our regular training schedule with you in 2021!

ASL Duties

Report safety hazards to EHS

Report security concerns to UTPD

Facilitate evacuation during an emergency

- Assist with emergency evacuations and drills
- Help account for evacuated personnel
- Manage emergency evacuation assistance for individuals in your area (e.g. mobility impaired individuals)

ASLs Know Best

ASLs know their people, ASLs know their spaces

You are the eyes and ears for both safety and security in your area

Make sure you understand where your area of responsibility lies

Helpful Phone Numbers

UTPD Dispatch - (713) 792-2890

Emergencies - 911

Environmental Health & Safety - (713) 500-8100

Facilities, Planning & Engineering - (713) 500-3498
(a.k.a. the FIXT line)

Review of Recent Incidents

ASLs awareness and understanding of safety has potentially prevented several incidents such as:

- Overheating refrigerators and older equipment
- Unattended microwaves
- Excessive, unsafe, or improper storage of items
- Hallway and security issues
- Use of space heaters

Excessive clutter
and potential fire
hazard – this is an
occupied space





Unoccupied
space used for
storage



Unsafe storage
of ladders and
chemicals

Use of
“unapproved”
space heater



Review of Recent Incidents

Because of our ASLs, many incidents are prevented before they happen!

Please continue to help identify any unsafe conditions.

Report anything that looks unsafe to EHS at 713 500 8100

Thank you!

In an emergency...

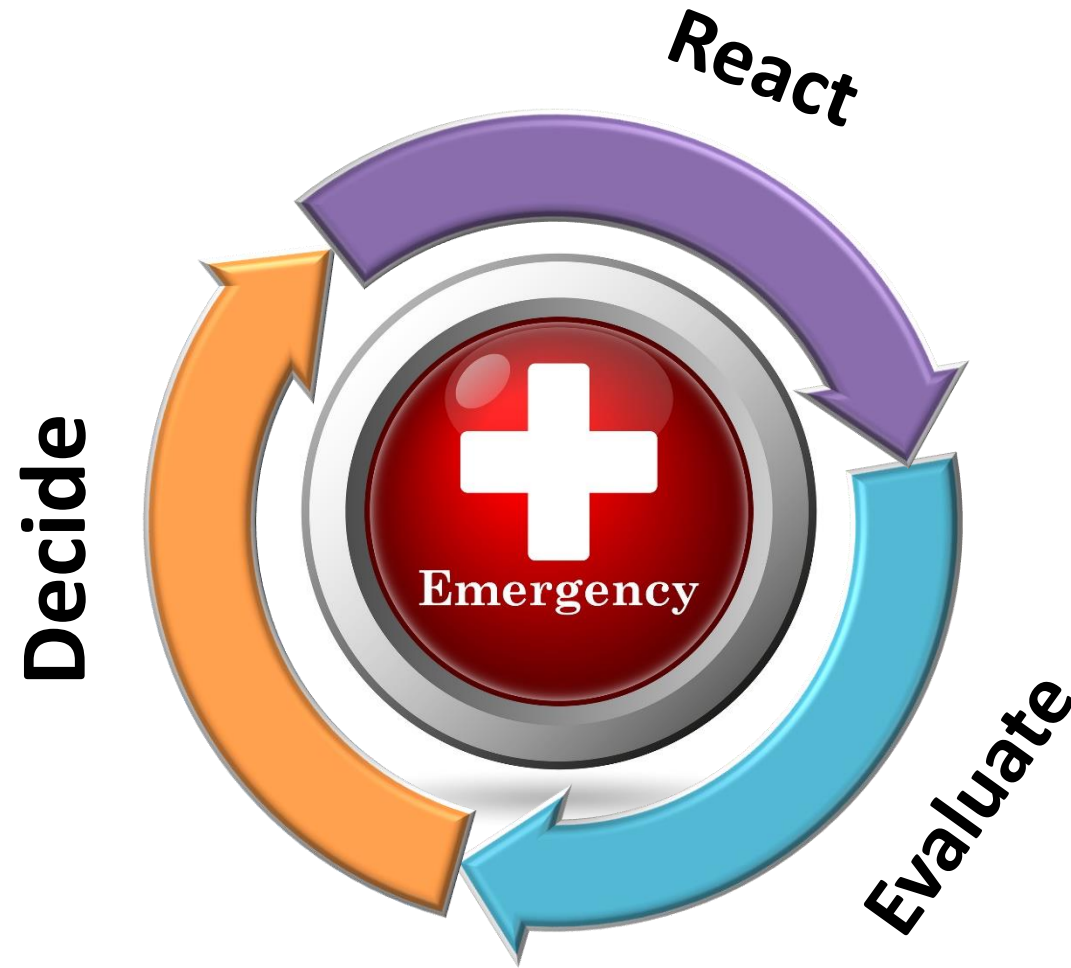

R
E
D

ASL Role



The Red Bag



Identifies you as the ASL – Wear during fire alarm and emergency events so others can identify you as the ASL

Organization

How it all comes together

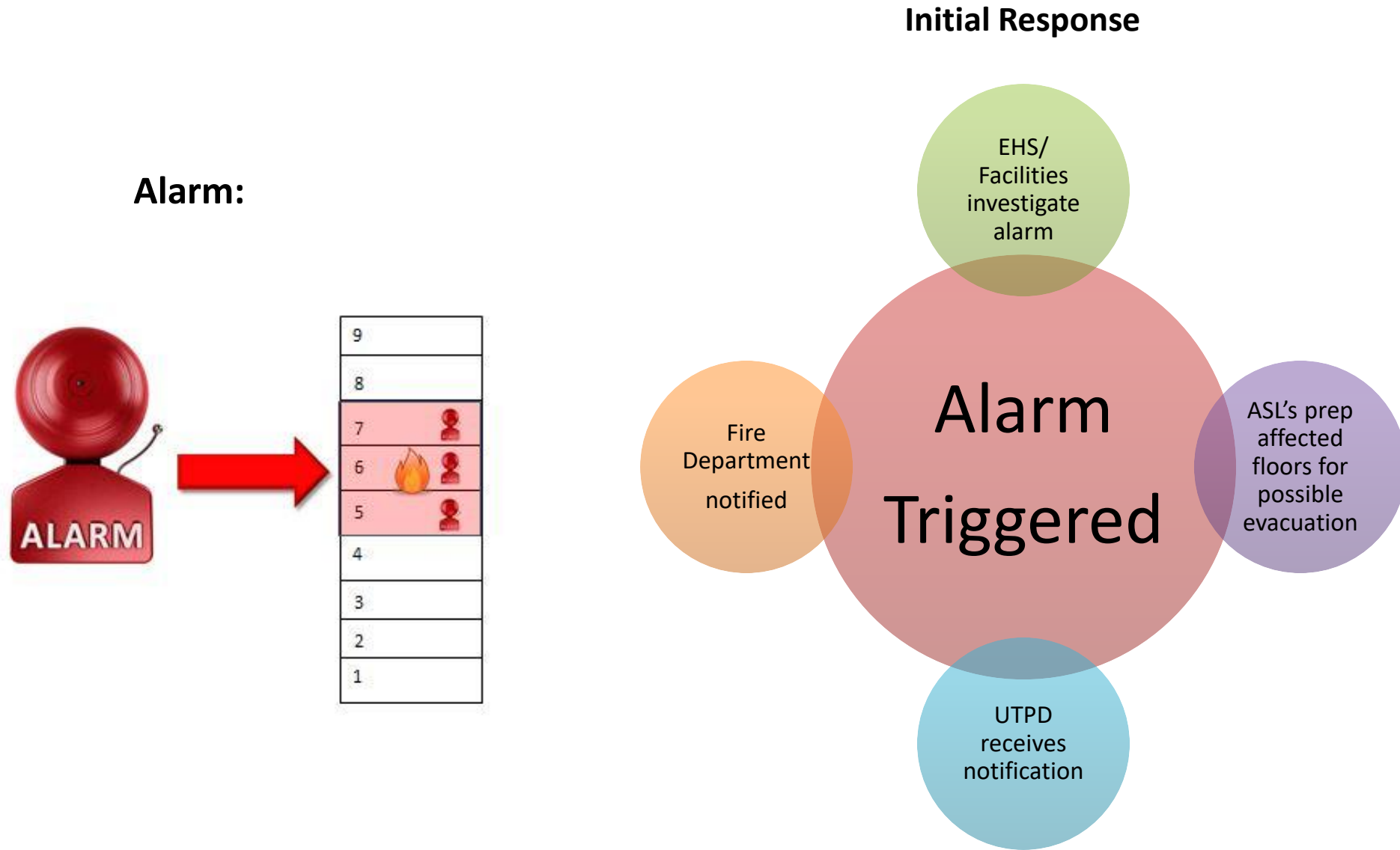

Designated Evacuation Point

At least **75 ft.** away from building



**ASSEMBLY
POINT**

*During an event, assist
keeping others calm
and coordinated*

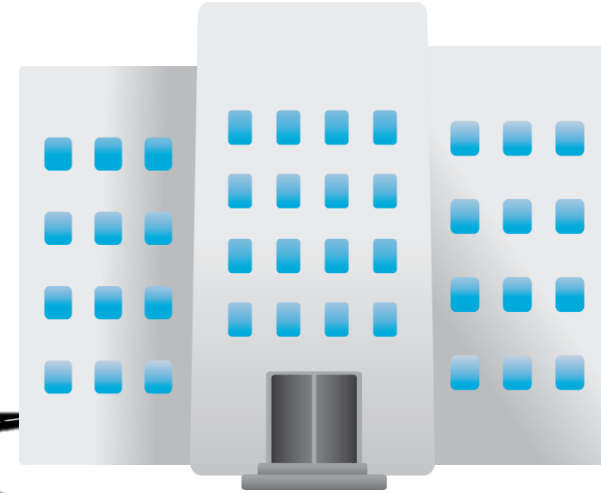

**EXIT
STRATEGY**

Corridor Clearance – HOOP Policy 88

- HOOP Policy is designed to keep the hallways, life safety equipment, and fire stairwells free and clear for those to access during an emergency event
- No exterior hallways, fire exits, fire stairwells, fire extinguishers, eye wash stations, showers, or fire pull stations should be blocked – 3 feet clearance required
- No rolling chairs, running electrical equipment, or combustible items in hallways or stairwells
- Any items placed in hallways, should be approved by EHS with current labeled sticker about the owner
- Contact EHS at 713 500 8100 with any questions

HOOP Policy 88

Corridor Clearance





AEDs
located
near
elevators



Stop The Bleed Kits

*Based on UTHealth Emergency Medicine faculty recommendations.

- 2x C.A.T.® Tourniquets
- 1x Israeli Emergency Bandage
- 2x Rolls Compressed Gauze
- 1x Pair Trauma Sheers
- 2x pair Nitrile Gloves
- 1x Eye/Face Shield
- 1x Roll Surgical Tape
- 1x Permanent Marker
- **Items do not expire**

**Located within AED boxes to assist during physical trauma – does not require specialized training*



SHERM Webpage

<https://www.uth.edu/safety>

The screenshot displays the SHERM webpage with a dark blue header. The header includes the UTHealth logo, navigation links (ABOUT, CAREERS, DIRECTORY, A-Z, WEBMAIL, INSIDE THE UNIVERSITY), a search bar, and a secondary navigation bar (SCHOOLS, STUDENTS, PATIENTS, RESEARCH, GIVE). The main content area features a grey banner with the text "Safety, Health, Environment, and Risk Management". On the left is a dark blue sidebar menu with the title "Safety, Health, Environment, and Risk Management" and a list of links. The link "Occupational Safety and Fire Prevention" is highlighted with a red box. The main content area has a section titled "SHERM Academics" with a paragraph of text and a list of academic activities. Below this is a video player with the title "The Ongoing Battle for Workers' Health" and a play button.

UTHealth
The University of Texas
Health Science Center at Houston

ABOUT CAREERS DIRECTORY A-Z WEBMAIL INSIDE THE UNIVERSITY 🔒 Search Term GO

SCHOOLS STUDENTS PATIENTS RESEARCH GIVE

Safety, Health, Environment, and Risk Management

Safety, Health, Environment, and Risk Management

- Home
- Contact Us
- Online Protocol System
- ▶ Biological Safety
- ▶ Chemical Safety
- ▶ Radiation Safety
- ▶ Environmental
- ▶ Occupational Safety and Fire Prevention**
- ▶ Risk Management and Insurance
- ▶ Occupational Health Clinical Services
- ▶ Ergonomics
- Emergency Procedures
- ▶ Required Training
- Manuals and Forms
- Safety Committees
- ▼ SHERM

SHERM Academics

SHERM maintains a strategic link with the UT School of Public Health's Division of Epidemiology, Human Genetics & Environmental Sciences (<https://sph.uth.tmc.edu/divisions/epidemiology-human-genetics-environmental-sciences/>) and participates in the following academic instruction activities:

- PH 2498 Workplace Safety Seminar Series (fall)
[Fall 2007 US PHS Seminar \(Power Point\)](#)
- PH 6998 Public Health Risk Communications (fall)
- PH 6998 Physical Agents (spring)
- PH 6998 Health and Safety Program Management (spring)

Ozone Interview with Bob Emery 7/20/2010
HIV Interview with Bob Emery 7/20/2010

For Those Who Know Don't Tell: Ongoing Battle for Workers' Health

The Ongoing Battle for Workers' Health

The video player shows a close-up of an older man with grey hair, wearing a dark suit jacket and a white shirt. He is speaking and looking slightly to the right. A play button is overlaid on the video.

ASL Webpage

Safety, Health, Environment, and Risk Management

Safety, Health, Environment, and Risk Management

Home

Contact Us

▶ Biological Safety

▶ Chemical Safety

▶ Radiation Safety

▶ Environmental Protection

▼ **Occupational Safety and Fire Prevention**

Occupational Safety Home

Fire Safety Report

Area Safety Liason

Hotworks Fire Prevention

Emergency Procedures

Campus Apartment

Emergency Evacuation

High Rise Building

Emergency Evacuation

Area Safety Liason

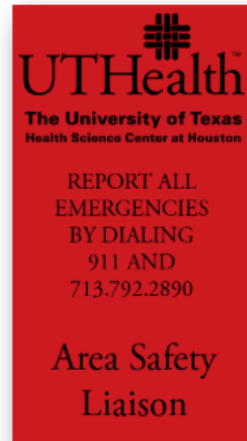

Area safety liaisons (ASLs) play an important role at UTHealth by assisting colleagues and other individuals in their area to be safe and healthy. The role of an ASL includes reporting safety hazards to EHS, reporting security concerns to UTPD, and facilitating evacuation during an emergency situation. The Occupational Safety and Fire Prevention Program helps to organize and administrate the ASL program by maintaining an active list of ASL volunteers, providing annual training to ASLs, and supporting ASLs who may have questions or concerns about their respective areas or buildings. Contact EHS if you are interested in serving as a volunteer ASL for your area.

Area Safety Liason Training, Information, and Forms

[OIA Emergency Communications](#) - Resources to know when the University is Open (Powerpoint)

[Injury Reporting](#) (Powerpoint)

[Environmental Management Systems](#) (Powerpoint)

[2017 ASL Training](#) (Powerpoint)

AED/CPR Training

Area Safety Liason Listings by Building

ASLs contacts:

[Campus wide ASL contact information](#) (Excel File)

Emergency Management Plan

[Emergency Management Plan](#) (weblink)

High Rise Evacuation Video

Safety, Health, Environment, and Risk Management

Safety, Health,
Environment, and Risk
Management

Home

Contact Us

▶ Biological Safety

▶ Chemical Safety

▶ Radiation Safety

▶ Environmental
Protection

▼ **Occupational Safety
and Fire Prevention**

Occupational Safety Home

Fire Safety Report

Area Safety Liason

Hotworks Fire Prevention

Emergency Procedures

Campus Apartment

Emergency Evacuation

**High Rise Building
Emergency Evacuation**

High Rise Building Emergency Evacuation

UTHealth has multiple types of buildings located throughout its campus.

The film below can assist building occupants' in familiarizing themselves with critical building safety and emergency response features. This film will demonstrate to occupants the fire detection and suppression, occupant notification, and emergency exits. For additional information and resources please contact Environment Health and Safety at 713-500-8100



*Please familiarize yourself
with the process for evacuations
at UTHealth:*

[UTHealth High Rise Evacuation](#)

Mobility Assistance Program

During an emergency evacuation, it is important to make sure that all occupants can exit the building safely

- For those who require assistance in exiting the building, please have them complete the [Evacuation Assistance Request Form](#)
- This confidential assistance program can be short term or long term and halted at any time by the individual
- Individuals who are injured, pregnant, or otherwise in need of temporary assistance in the event of an emergency are eligible for this
- For those in a high rise, an Evacu-trac can also be made available to them

Evacu-Trac (1:55)

<https://www.youtube.com/watch?v=zM6LHHKASxY>



Mobility Assistance Program

Emergency Evacuation Assistance Request

UTHSC-H seeks to protect its community from the effects of unpredictable situations by establishing specific procedures for coping with local emergencies. If you need assistance to evacuate the building during such an emergency, please complete the form below and return it in person or via inter office mail to Environmental Health & Safety in OCB 1.330 or fax the form to 713-500-8111.

Upon receipt, a member of the Environmental Safety & Health team will be contacting you to confirm the delivery of the form, to discuss the program with you. He or she will then update the HFD Fire Depository Box and notify UTPD.

Name (please print): _____

Building and Room Number: _____

Phone Number: _____

I will need assistance in evacuating the building on a:

- Temporary basis from _____ until approximately _____
- Throughout my employment/studies at UTHSC-H
- I will no longer need emergency evacuation assistance

Comment: (optional) _____

A member of the Environmental Safety & Health team will be contacting you upon the receipt of this form to discuss the program and to ensure you know how to respond in the event of a building emergency. If you would like a more detailed, in person, discussion of the program, please check the box below:

- I would like a safety specialist to speak with me in person at my location about the evacuation concerns specific to my location and provide greater detail about the Emergency Evacuation Assistance Program.

ASL Changes or Additions?

Please let us know if any changes are needed, such as:

- You are no longer able to serve as an ASL
- You know of an area that does not have representation of an ASL

Contact EHS at 713 500 8100

THANK YOU!

Questions / comments / concerns?

Contact EHS at 713 500 8100

Please visit our ASL webpage at:

<https://www.uth.edu/safety/occupational-safety-and-fire-prevention/asl.htm>